

HR-4D DTH HAMMER

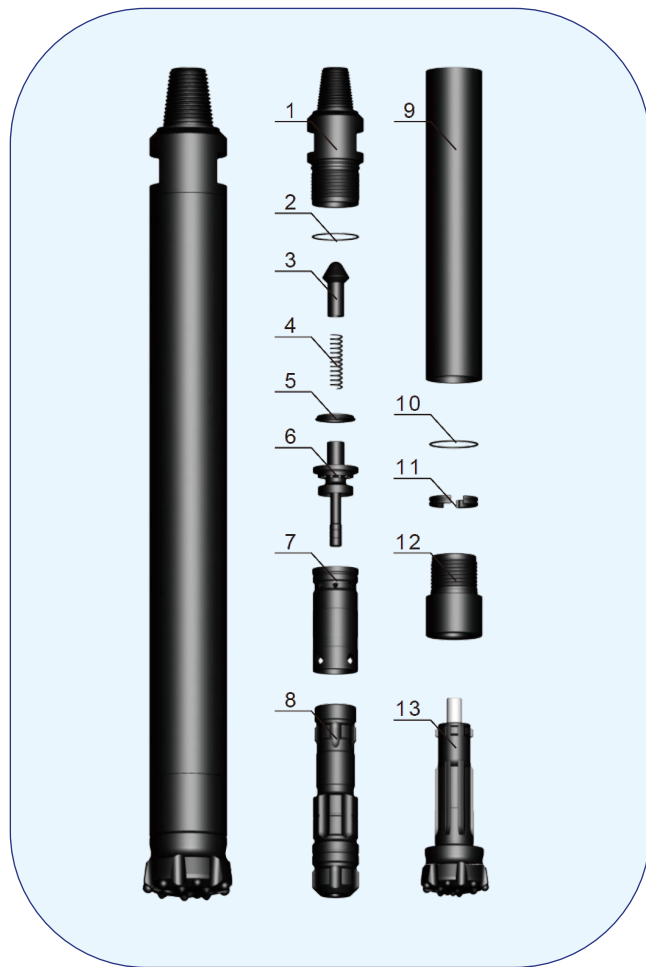

HR-4D DTH Hammers

| Item Description | Weight (Kg) | Part Number |
|-------------------------|-------------|-------------|
| ① Top Sub | 6.55 | HR-4D-01 |
| ② "O" Ring of Top Sub | 0.01 | HR-4D-02 |
| ③ Check Valve | 0.35 | HR-4D-03 |
| ④ Spring | 0.05 | HR-4D-04 |
| ⑤ Compression Buffer | 0.15 | HR-4D-05 |
| ⑥ Air Distributor | 1.40 | HR-4D-06 |
| ⑦ Internal Cylinder | 1.35 | HR-4D-07 |
| ⑧ Piston | 9.53 | HR-4D-08 |
| ⑨ External Cylinder | 15.4 | HR-4D-09 |
| ⑩ "O" Ring of Stop Ring | 0.01 | HR-4D-10 |
| ⑪ Stop Ring | 0.20 | HR-4D-11 |
| ⑫ Drive Chuck | 3.60 | HR-4D-12 |
| ⑬ Drill Bit | | HR-4D-13 |

Technical Data

| Length(Less bit) | Weigth(Less bit) | External Diameter | Bit Shank | Hole Range | Connection Thread | | |
|------------------|------------------------------------|-------------------|--------------------------|---|-------------------|---------|-------|
| 951 mm | 38.6kgs | Φ 99 mm | DHD340A COP44 HD45 | Φ 110 – Φ 135 | API 2 3/8" REG | | |
| Working Pressure | Impact rate at 1.7 Mpa (reference) | Speed recommended | Pull force recommended | Reference Air consumption (m ³ /min) | | | |
| 10-25 Bar | 30Hz | 30-70 rpm | 8.0 kN | 14Bar | 17.2Bar | 20.7Bar | 24Bar |
| | | | | 7.4 | 9.8 | 12.3 | 15.0 |