

## HQL60 DTH HAMMER

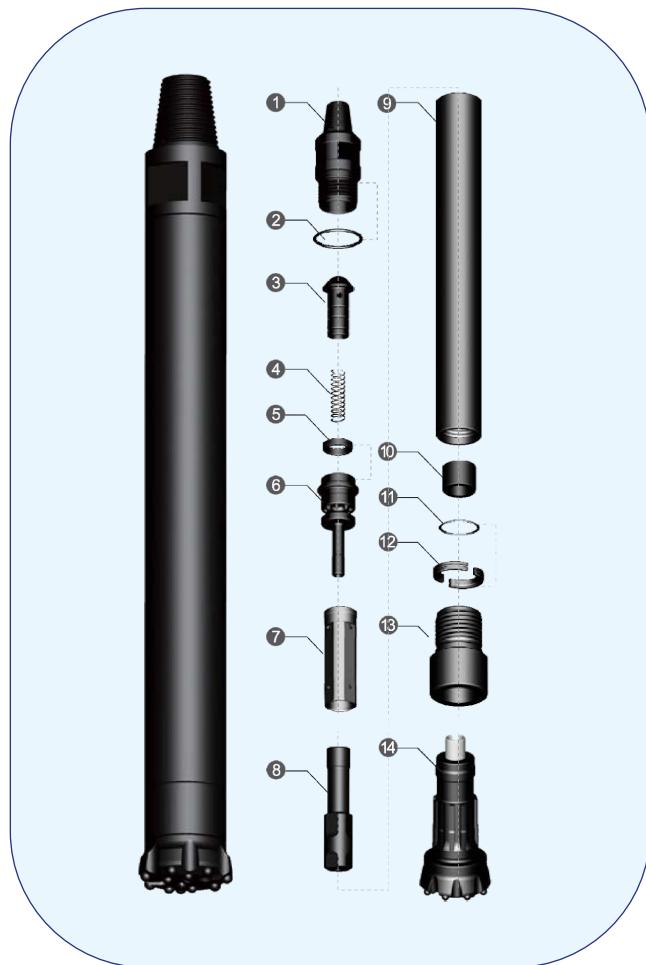

HQL60. Hammers

Item Description	Weight (Kg)	Part Number
① Top Sub	20.00	HQL60-TSUB
② "O" Ring of Top Sub	0.02	HQL60-SR-T SUB
③ Check Valve	1.00	HQL60-CVALVE
④ Spring	0.10	HQL60-SPRING
⑤ Compression Buffer	0.10	HQL60-CBUFFER
⑥ Air Distributor	6.00	HQL60-DIST
⑦ Internal Cylinder	5.00	HQL60-ICYL
⑧ Piston	23.50	HQL60-PISTON
⑨ External Cylinder	31.00	HQL60-ECYL
⑩ Guided Sleeve	1.00	HQL60-BUSH
⑪ "O" Ring of Stop Ring	0.02	HQL60-SR-RING
⑫ Stop Ring	0.60	HQL60-SRING
⑬ Drive Chuck	5.40	HQL60-DCHUCK
⑭ Drill Bit		HQL60-165CC-TV

### Technical Data

Length(Less bit)	Weigth(Less bit)	External Diameter	Bit Shank	Hole Range	Connection Thread
1212mm	95.0Kg	φ 148mm	Cop64-G QL60 HQL60	φ 165 – φ 178	API 3 1/2" REG
Box Size	Impact rate at 1.7 Mpa	Recommended rotation speed		Air Consumption 300-350(Psi)	
1270x170x200mm	23HZ	20-30r/min		600-900(CFM)	